

PA System in Buckingham Community Hall used for U3A events.

Steve Meakin 25-10-2023

This document gives an overview as to how the PA System is set up in the Community Centre. Contents as follows:

Page 2 – Diagram showing physical location and connections of the parts of the system

Page 3 – Connections for the Wireless Microphones

Page 4 - Connections for the Wireless Receiver

Page 5 – Connections for the Sound Mixer

Page 6 – Connections for the Amplifier/Speakers

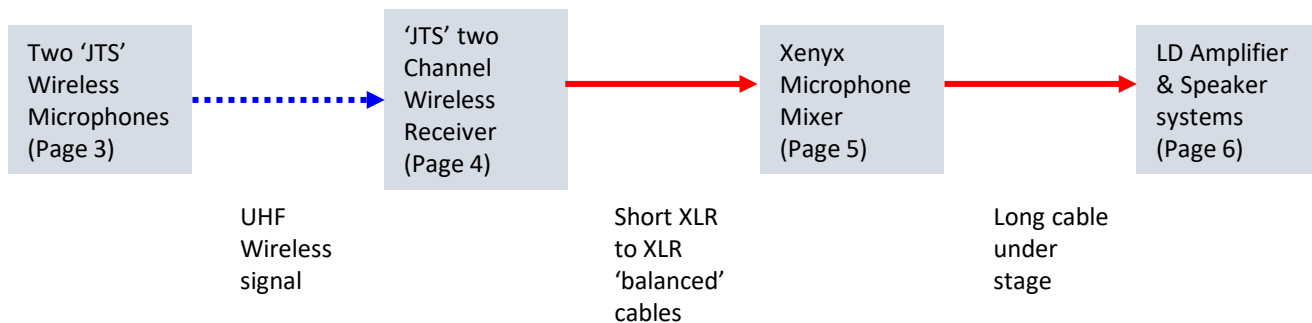

PA System in Buckingham Community Hall used for U3A events. Steve M 25-10-2023

Sound Equipment cupboard
(Plug/unplug 2 mains plugs below)

Power switch for front speaker
(located behind curtain and rhs socket switch)

Power switch
For front speaker
(lhs socket switch)

Rhs
switch is
power
for audio
equip

Speaker
on top of
cupboard

Speaker
on top of
cupboard

Stage

Channel 2 – power
slide switch on base

Channel 14

Speaker amp with
subwoofer
(rocker mains switch at
back of sub). Can leave on.

Speaker amp with
subwoofer
(rocker mains switch at
back of sub). Can leave on.

Projector
screen
remote kept
on wall just
inside 2nd
door on right
(after 'Staff'
door). Screen
comes down
from ceiling
above stage
but no
permanent
projector

Main mixer in sound equipment cupboard

Main
handheld
mic vol

Ear/lapel
mic vol

Cupboard at
back of hall
containing
light switches

ITS UHF
CH 2 CH 14

N.B. Wireless Microphones use 1.5v AA Batteries (which may be rechargeable)

4-3 PT-990B-TH(mi) Body-pack Transmitter

- ① Mic. input
- ② Power On/off switch
- ③ Antenna
- ④ LCD display
- ⑤ Set button
- ⑥ Up button
- ⑦ Down button
- ⑧ Battery tray button
- ⑨ AF level control
- ⑩ Belt clip
- ⑪ Battery tray
- ⑫ Audio adjusting sticker

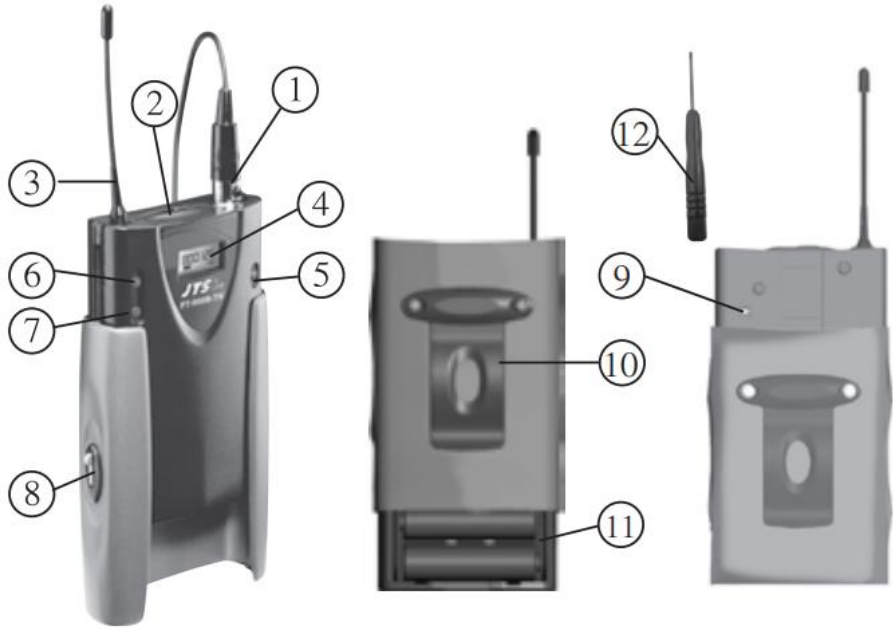

4-2 Handheld Transmitter // Mh-

- ⑫ Interchangeable dynamic capsule
- ⑬ LCD display
- ⑭ Down button
- ⑮ UP button
- ⑯ Set button
- ⑰ Battery tray button
- ⑱ Battery tray
- ⑲ Power On/Off switch
- ⑳ Mute On/Off switch

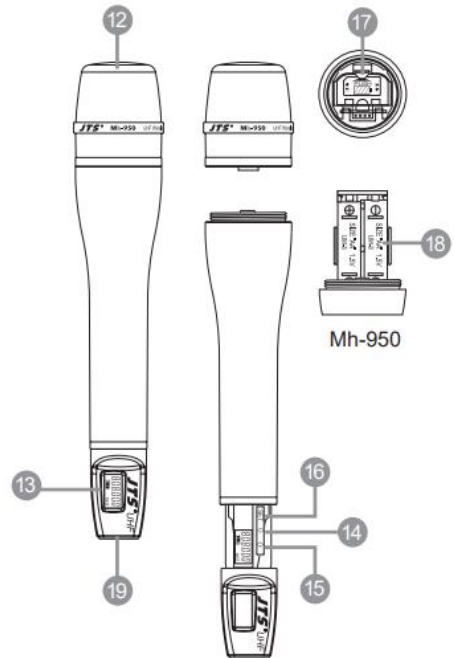

4-1 Dual Channel PLL Diversity Receiver // US-902D Pro

- ① Power Switch
- ② Channel Selector (Up/Down)
- ③ LCD panel
- ④ Volume control
- ⑤ Antenna
- ⑥ Squelch level adjustor
- ⑦ DCV Input (12-18V DC/300mA)
- ⑧ Unbalanced Ø6.3mm jack socket
- ⑨ Balanced XLR socket

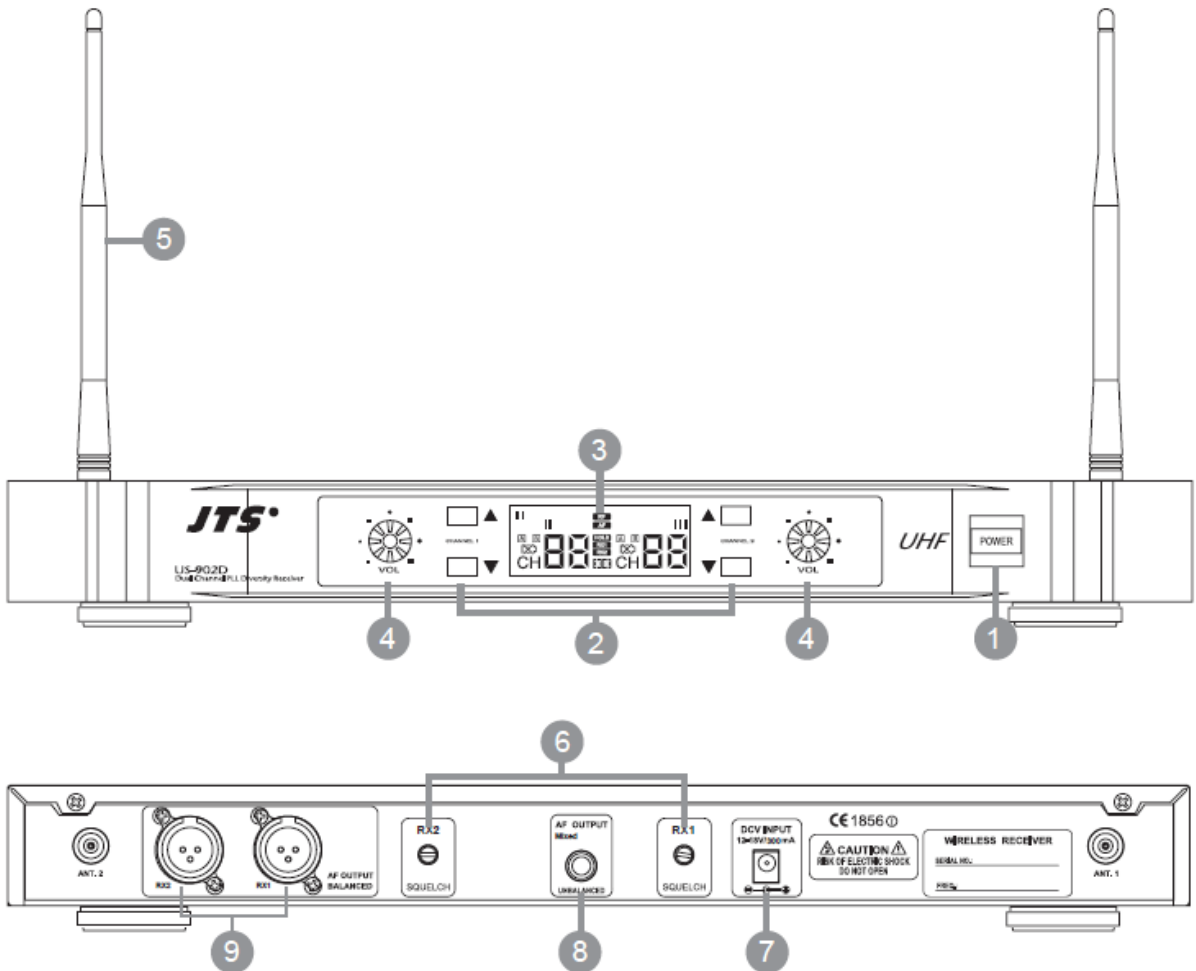

XENYX802 Mixer

XLR Cable in from wireless receiver (for hand-held mic going into channel 1

XLR Cable in from wireless receiver (for lapel mic going into channel 2

Power in

Line out (jack plug) going to Left hand amp/speaker

Line out (jack plug) going to Right hand amp/speaker

Main handheld mic vol

Ear/lapel mic vol



LD MAUI28 Amp/Speakers



Volume controls
for main and sub-
woofer speaker

Line inputs from
Sound Mixer

Mains power
connector and switch