

Instructions on how to use the U3A Trust Fiesta Plus Speaker-Amplifier

Index	page 1
Connecting the Sennheiser Microphone	page 2
Using the ProSound radio microphone	page 3
Connecting devices by cable	page 4
Connecting devices by Bluetooth	page 5

N.B. Using the Sennheiser Microphone (see page 2) is the simplest way to set up the PA system

Contents checklist for accessories with the Speaker Amplifier



Microphone cable (3 pin XLR to 6.25mm jack plug)
Sennheiser microphone
Mains cable



Aux cable – jack to jack (uses microphone input)
Aux cable – Phono plugs to 6.25mm jack plugs
Aux cable – Phono plugs to 3.5mm stereo jack

Contents checklist for accessories with the ProSound radio receiver



Channel B Radio microphone
12-volt power supply
Jack-to jack to connect receiver to amp'
'Tie microphone' & 'Headset microphone'
Bodypack radio transmitter

Top indicator goes green when amp' is switched on

Connecting the Sennheiser Microphone

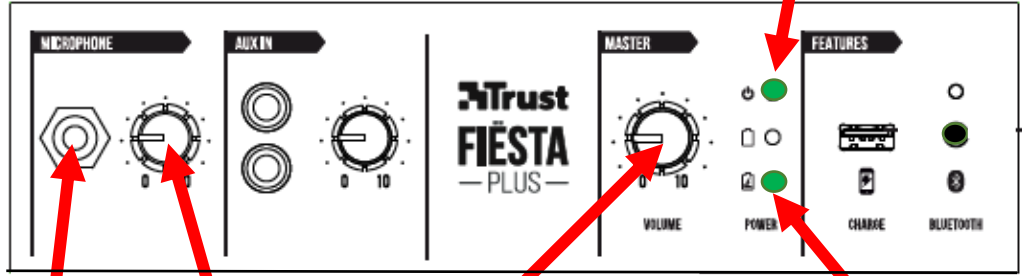

Microphone volume control

Master volume control

Shows amp' is connected to mains (but not switched on)

Microphone jack plugs into microphone socket



3 pin XLR plug goes into microphone

Instructions to use the Sennheiser Wired Microphone

1. Plug in mains cable into back of amp'. The lower led on the front panel should turn green
2. Press switch to setting 'II' on back of amp' to turn on power. Top indicator goes green. (If you use the 'I' switch setting the amp' should switch off after 3 hours)
3. Plug the jack plug of the 'jack plug to XLR socket' cable into the microphone input of the Trust amp' and the XLR end into the microphone
4. Set the master volume control initially to about 70%. (You can tweak it later)
5. Use the microphone volume control on the front of the amp' to suit. (Usually, you turn up the volume until you just start to get a howl from acoustic feedback and then 'back it off' until there is no feedback)

Please note:

- This is the most straightforward way to get voice amplification and the Sennheiser microphone is 'good quality'
- You can use the jack-to-jack cable to plug into the microphone socket for an electric guitar etc.



- The amp' only works when connected to the mains – there is no internal battery
- You can use the 'AUX' input at the same time as the microphone. E.g., for a soundtrack on a phone or iPad

Connecting the Radio Microphone

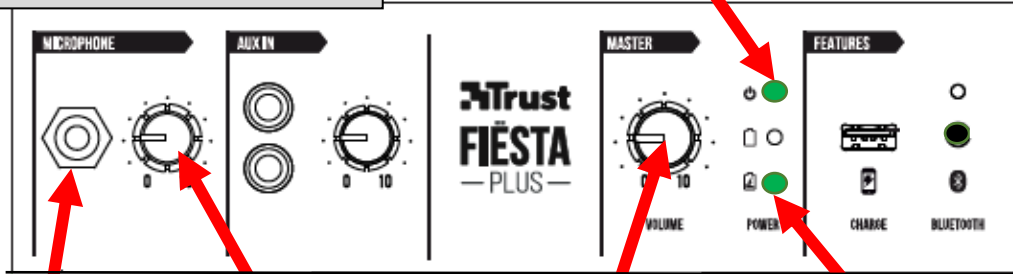

Top indicator goes green when amp' is switched on

Microphone volume control

Master volume control

Shows amp' is connected to mains (but not switched on)

Jack to jack cable goes into back of Microphone receiver and into front of amp'

Connect to 12 volt power pack

Power switch



Back of wireless microphone receiver



Use either the handheld mic' or the bodypack with tie mic' or headset mic' plugged in to it

Instructions to use the ProSound Wireless Microphone or Bodypack

1. Plug the mains cable into the Trust speaker amp'
2. Plug the 12-volt power pack supply into the back of the receiver
3. Plug one end of the 'jack to jack' cable into the microphone socket of the Trust amp' and the other end into the jack socket on the back of the receiver
4. Make sure the either the microphone or the bodypack has two working alkaline AA batteries inserted into it in the right way
5. Switch on the Trust amp' so that both green LEDs are showing on the front panel
6. Switch on the wireless receiver at the back and the red led on the front of the receiver should illuminate
7. Switch on the radio microphone or bodypack and the red led should briefly flash. (For the bodypack you can plug in either the 'tie microphone' or 'headset mic' using the miniature jack plug).
8. As soon as you switch on the microphone/bodypack2 the green light on channel B should illuminate. This means the microphone or bodypack is transmitting and being received by the receiver 😊
9. Set the volume control on the receiver and the master volume control on the amp' to about 70% of maximum
10. Use the microphone volume control on the front of the amp' to suit. (Usually, you turn up the volume until you just start to get a howl from acoustic feedback and then 'back it off' until there is no feedback)

You can use either the handheld wireless microphone or the bodypack with a tie or headset microphone. Only one microphone can be used at a time though.



Channel A not in use

Volume control

Front of receiver

Green light shows radio signal being received

Connecting AUX Devices

Top indicator goes green when amp' is switched on

5. Connecting Devices

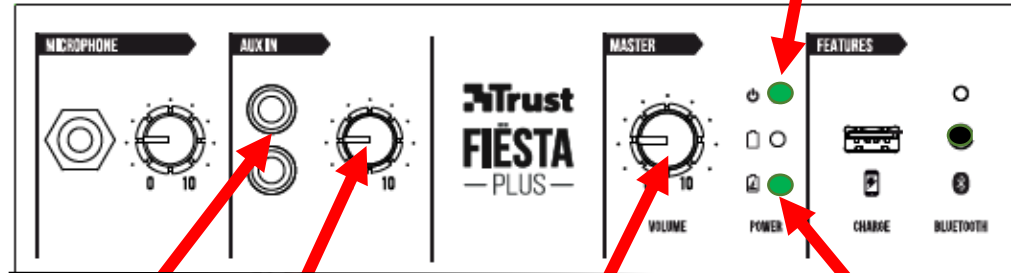

AUX volume control

Master volume control

Shows amp' is connected to mains (but not switched on)

Plug red & white phono plugs into AUX input

Other end of cable goes into headphone or output socket on device
3.5mm and 6.25mm jack plugs provided

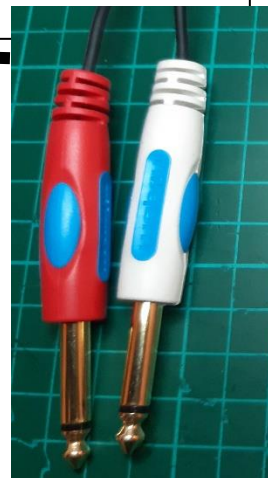

Instructions to use the AUX input

1. Plug in mains cable into back of amp'. The lower led on the front panel should turn green
2. Press switch to setting '11' on back of amp' to turn on power. Top indicator goes green. (If you use the '1' switch setting the amp' should switch off after 3 hours)
3. Plug one of the cables that uses two phono plugs cable into the AUX input of the Trust amp' and the other end into your device which has an output or headphone socket and might be a keyboard, mobile phone, or iPad
4. Set the master volume control initially to about 70%. (You can tweak it later)
5. Use the AUX volume control on the front of the amp' to suit.

Please note:

- The amp' only works when connected to the mains – there is no internal battery
- You can use the microphone input at the same time as the AUX input

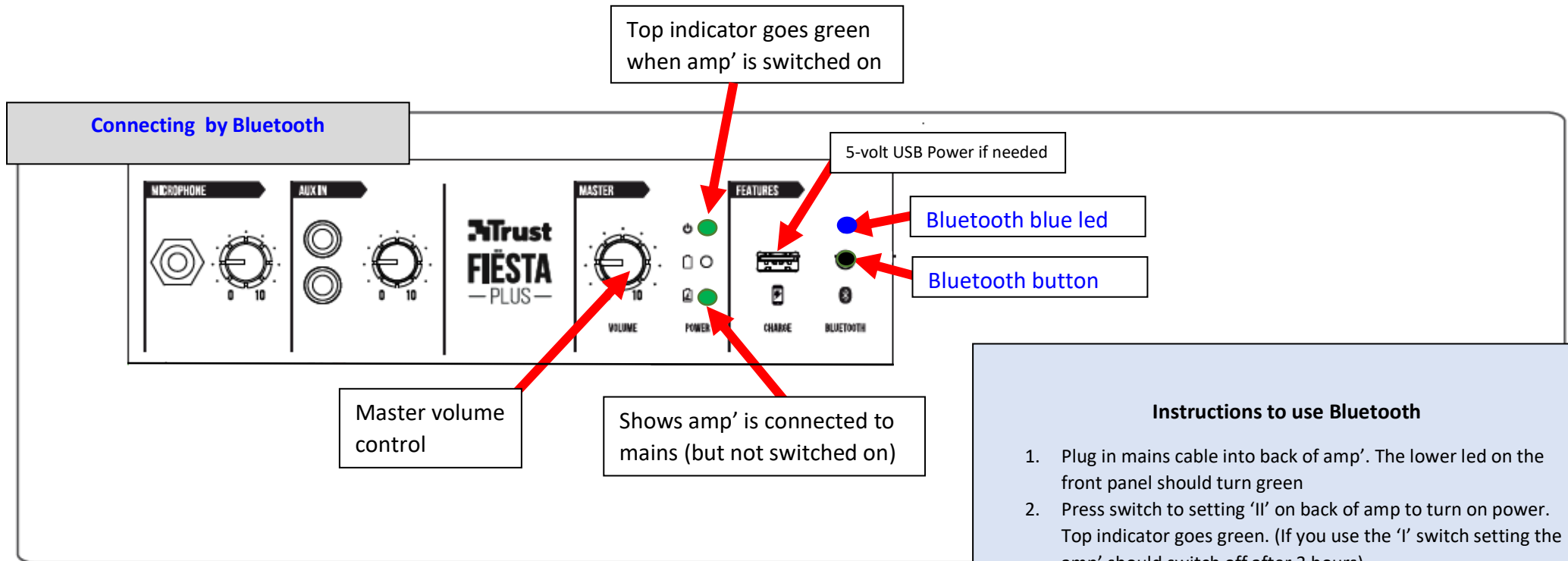

Instructions to use Bluetooth

1. Plug in mains cable into back of amp'. The lower led on the front panel should turn green
2. Press switch to setting 'II' on back of amp to turn on power. Top indicator goes green. (If you use the 'I' switch setting the amp' should switch off after 3 hours)
3. Press the Bluetooth button which will make the blue led flash
4. Pair with your Bluetooth device & the led will stay blue
5. You can now play sound from your connected device using the master volume control and the volume control on your device

Please note:

- Bluetooth only works over about 10 metres and needs a 'line of sight'. Any barrier including people may cause the signal to 'break up'.
- The amp' only works when connected to the mains – there is no internal battery
- You can use the microphone input at the same time as the AUX input
- There is a 5-volt USB socket on the front panel that can be used to power small devices